

RO-EE/UU

Catalog Code **W6083**

Stainless steel posts.

In case of using this rod, without buying a new rod, it is possible to be set the holder or the like to the various optical axis height.

- The through-hole of the side of the rod is used to insert the hex wrench. By using this, it can be easily attached and detached to the holder or the like.
- Accessories can be selected from the type of M4 and M6 or inch type.



Example

Guide

▶ Custom sizes not listed in the catalog are available. Use the QuestionSheet for Special Order Posts. [WEB Reference](#) **Catalog Code** W6053

Outline Drawing

RO-EE/UU

special screw SC-M4-14EE...1 screws, CHS-M4-M6-5...1 screws (EE)
special screw SC-8U-14UU...1 screws, CHS-1/4-8U-5...1 screws (UU)

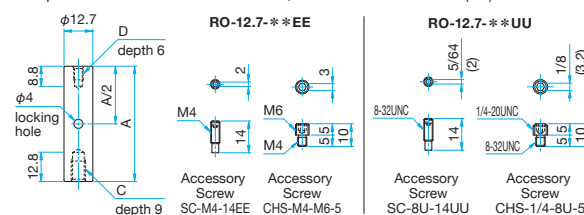

C: EE type M6P1, UU type 1/4-20UNC
D: EE type M4, UU type 8-32UNC

Specifications

Part Number		A [mm]	Weight [kg]
METRIC	INCH		
RO-12.7-25.4EE	RO-12.7-25.4UU	25.4	0.026
RO-12.7-38.1EE	RO-12.7-38.1UU	38.1	0.038
RO-12.7-50.8EE	RO-12.7-50.8UU	50.8	0.051
RO-12.7-76.2EE	RO-12.7-76.2UU	76.2	0.077
RO-12.7-101.6EE	RO-12.7-101.6UU	101.6	0.102
RO-12.7-152.4EE	RO-12.7-152.4UU	152.4	0.153
RO-12.7-203.2EE	RO-12.7-203.2UU	203.2	0.204
RO-12.7-304.8EE	RO-12.7-304.8UU	304.8	0.306

Primary material: Stainless Steel
Finish: None

CHS

Catalog Code **W6084**

CHS, as a conversion screw, is processed by different thread at both ends, in case of M6 or 1/4 inch for holder side and M4 or 8-32UNC for stand side are different, it can be used as a connecting screws for mounting.



- We will prepare the two types of screws INCH and METRIC.
- If you have misplaced the included screws for extension rod, it can be purchased separately.

Guide

▶ It is used for extension rod (RO-12.7-**-**).

Outline Drawing

CHS

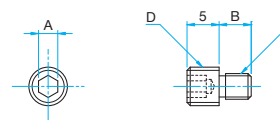

Specifications

Part Number	A [mm]	B [mm]	C	D	Quantity [Pieces]
CHS-M4-M6-5	3	5	M4	M6 P1	10
CHS-M4-M6-9	3	9	M4	M6 P1	10
CHS-1/4-8U-5	1/8 (3.2)	5	8-32UNC	1/4-20UNC	10
CHS-1/4-8U-9	1/8 (3.2)	9	8-32UNC	1/4-20UNC	10

Primary material: Stainless Steel
Finish: None